

Table-Top Grill

**giles &
posner®**

INSTRUCTION MANUAL

Please retain instructions for future reference.

Safety Instructions

When using electrical appliances, basic safety precautions should always be followed.

Check that the voltage indicated on the rating plate corresponds with that of the local network before connecting the appliance to the mains power supply.

Children aged from 8 years and people with reduced physical, sensory or mental capabilities or lack of experience and knowledge can use, and clean, this appliance, only if they have been given supervision or instruction concerning use of the appliance in a safe way and understand the hazards involved.

This appliance is not a toy; Children should not play with the appliance.

This appliance contains no user serviceable parts. If the power supply cord, plug or any part of the appliance is malfunctioning or if it has been dropped or damaged, only a qualified electrician should carry out repairs. Improper repairs may place the user at risk of harm.

Keep the appliance and its power supply cord away from heat or sharp edges that could cause damage. Keep power cord away from children. Keep the power supply cord away from any parts of the appliance that may become hot during use.

Keep the appliance away from other heat emitting appliances.

Do not operate the appliance with wet hands.

Do not leave the appliance unattended whilst connected to the mains power supply.

Do not remove the appliance from the mains power supply by pulling the cord; switch it off and remove the plug by hand.

Do not pull or carry the appliance by its power supply cord.

Do not move the appliance whilst it is in use.

Do not use sharp or abrasive items with this appliance; use only heat-resistant plastic or wooden spatulas to avoid damaging the non-stick surface.

Switch off the appliance and disconnect it from the mains power supply before changing or fitting accessories.

Always unplug the appliance after use, and allow cooling before performing any cleaning, user maintenance or storing away.

Use of an extension cord with the appliance is not recommended.

This appliance should not be operated by means of an external timer or separate remote control system, other than that supplied with this appliance.

This appliance is intended for domestic use only. It should not be used for commercial purposes.

The outer surface of the appliance may get hot during operation.



Caution: Hot surface – do not touch the hot section or heating components of the appliance.

Take care not to pour water on the heating element.

Warning: Keep the appliance away from flammable materials.

Care and Maintenance

Before attempting any cleaning or maintenance, unplug the table-top grill from the mains power supply and allow to cool fully.

STEP 1: Wipe the lower grill housing with a soft, damp cloth and dry thoroughly.

STEP 2: Clean the accessories in warm, soapy water, then rinse and dry thoroughly.

STEP 3: Remove baked on food by applying a small amount of warm water mixed with a mild detergent to the cooking plate, then wipe them clean with a paper towel. Use a nonabrasive scourer if the food is difficult to remove.

Do not immerse the table-top grill in water or any other liquid.

Never use harsh or abrasive cleaning detergents or scourers to clean the table-top grill or its accessories, as this could damage the surface.

Note: The table-top grill should be cleaned after each use.

Warning: The drip tray will gather oil and fat, which may still be hot after use. Allow it to cool fully before carefully removing the drip tray for cleaning.

Description of Parts

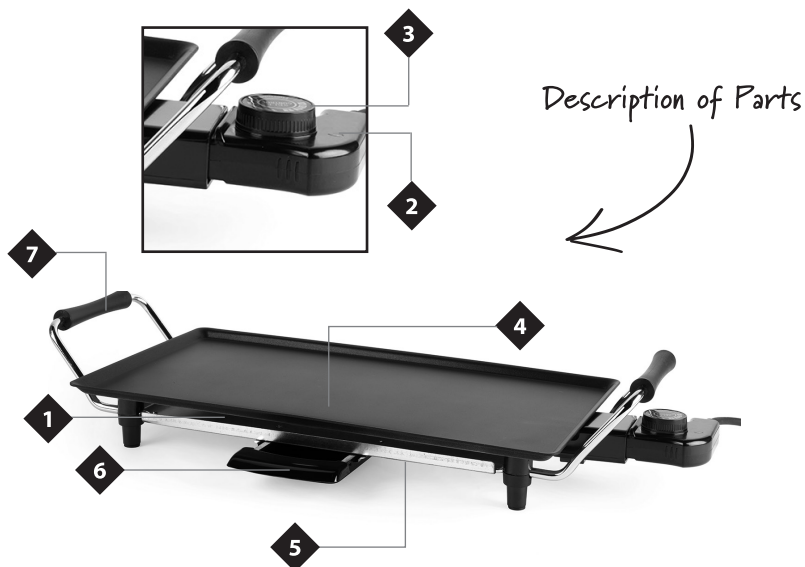

- | | |
|------------------------------|-------------------------|
| 1. Table-Top Grill main unit | 5. Lower grill housing |
| 2. Indicator light | 6. Drip tray |
| 3. Temperature control dial | 7. Cool-touch handle(s) |
| 4. Cooking plate | |

Instructions for Use

Before First Use

STEP 1: Check that the table-top grill is switched off and unplugged from the mains power supply.

STEP 2: Wipe the lower grill housing with a soft, damp cloth and dry thoroughly.

STEP 3: Clean the accessories in warm, soapy water, then rinse and dry thoroughly.

Note: When using the table-top grill for the first time, a slight smoke or odour may be emitted. This is normal and will soon subside. Allow for sufficient ventilation around the table-top grill.

Using the Table-Top Grill

STEP 1: Place the table-top grill main unit on a horizontal, stable, dry, heat-resistant surface, in a well-ventilated area. Prepare the ingredients that are to be cooked.

STEP 2: Plug in and switch on the table-top grill at the mains power supply, making sure the temperature control dial is set to '0'.

STEP 3: Select the required temperature by turning the temperature control dial in a clockwise direction; the red indicator light will turn on, signalling that the table-top grill is heating up.

STEP 4: Preheat the table-top grill for approx. 5–8 minutes. The red indicator light will turn off once the required temperature has been reached.

STEP 5: Place the prepared ingredients onto the cooking plate. Cook for approx. 3–8 minutes, depending on the type of ingredients and the temperature used.

STEP 6: Once cooking is complete, carefully remove the food with a heat-resistant plastic or wooden spatula.

STEP 7: Turn the temperature control dial in an anticlockwise direction to the 'off' position, then switch off and unplug the table-top grill from the mains power supply. Allow the table-top grill to cool down before cleaning.

Note: Always preheat the cooking plate before starting to cook.

Carefully apply a thin coat of cooking oil to the cooking plate, rubbing it in carefully with a paper towel. This will help to prolong the life of the non-stick coating.

During use, the red indicator will cycle on and off to signal that the table-top grill is maintaining the selected temperature.

Caution: The cooking plate gets very hot during use; always use heat-resistant gloves to avoid injury.

Take care when placing food onto the cooking plate, as fatty, oily or wet ingredients may create splashback, which could cause injury.

Temperature Table

Setting:	Temperature:
1	100–150 °C
2	130–180 °C
3	150–200 °C
4	180–230 °C
5	200–250 °C



Storage

Check that the table-top grill is cool, clean and dry before storing in a cool, dry place.
Never wrap the cord tightly around the table-top grill; wrap it loosely to avoid causing damage.

Specifications

Product code: EK4428G

Input: 220–240 V ~ 50/60 Hz

Output: 2000 W

Connection to the mains

Please check that the voltage indicated on the product corresponds with your supply voltage.

Important

As the colours in the mains lead of this appliance may not correspond with the coloured markings identifying the terminals in your plug, please proceed as follows:

The wires in the mains lead are coloured in accordance with the following code:

Blue Neutral (N)

Brown Live (L)

Green/Yellow Earth (\perp)

FOR UK USE ONLY - Plug fitting details
(where applicable).

The wire coloured BLUE is the NEUTRAL and must be connected to the terminal marked N or coloured BLACK.

The wire coloured BROWN is the LIVE wire and must be connected to the terminal marked L or coloured RED.

The wire coloured GREEN/YELLOW must be connected to the terminal marked with the letter E or marked \perp .

On no account must either the BROWN or the BLUE wire be connected to the EARTH terminal (\perp).

Always ensure that the cord grip is fastened correctly.

The plug must be fitted with a fuse of the same rating already fitted and conforming to BS 1362 and be ASTA approved.

If in doubt consult a qualified electrician who will be pleased to do this for you.

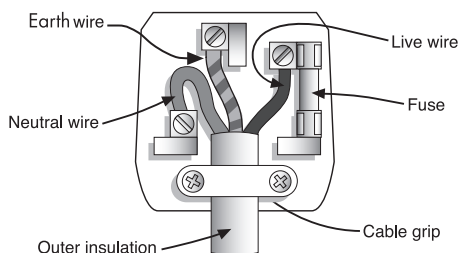

Non-rewireable mains plug

If your appliance is supplied with a non-rewireable plug fitted to the mains lead and should the fuse need replacing, you must use an ASTA approved one (conforming to BS 1362 of the same rating).

If in doubt, consult a qualified electrician who will be pleased to do this for you.

If you need to remove the plug - DISCONNECT IT FROM THE MAINS and then cut it off the mains lead and immediately dispose of it safely. Never attempt to reuse the plug or insert it into a socket outlet as there is a danger of an electric shock.

**UP Global Sourcing UK Ltd.,
UK. Manchester OL9 0DD.
Germany. 51149 Köln.**

If this product does not reach you in an acceptable condition please contact our Customer Services Department at **www.gilesandposner.com**

Please have your delivery note to hand as details from it will be required.

If you wish to return this product please return it to the retailer from where it was purchased with your receipt (subject to their terms and conditions).

Guarantee

All products purchased as new carry a manufacturer's guarantee; the time period of the guarantee will vary dependent upon the product. Where reasonable proof of purchase can be provided, Giles and Posner will provide a standard 12 month guarantee with the retailer from the date of purchase. This is only applicable when products have been used as instructed for their intended, domestic use. Any misuse or dismantling of products will invalidate any guarantee.

Under the guarantee, we undertake to repair or replace free of any charge any parts found to be defective. In the event that we cannot provide an exact replacement, a similar product will be offered or the cost refunded. Any damages from daily wear and tear are not covered by this guarantee, nor are consumables such as plugs, fuses etc.

Please note that the above terms and conditions may be updated from time to time and we therefore recommend that you check these each time you revisit the website.

Nothing in this guarantee or in the instructions relating to this product excludes, restricts or otherwise affects your statutory rights.

The crossed out wheelie bin symbol on this item indicates that this appliance needs to be disposed of in an environmentally friendly way when it becomes of no further use or has worn out. Contact your local authority for details of where to take the item for recycling.





Manufactured by:
UP Global Sourcing UK Ltd.,
UK, Manchester OL9 0DD,
Germany, 51149 Köln.

Made in China.

CD270721/MD000000/V1



ULTIMATE PRODUCTS
HOME OF BRANDS

Manchester
OL9 0DD
United Kingdom
www.upgs.com

Artworker:	SCARLETT CHESTER-ROBERTS
Date:	27/07/2021
Project Name:	EEK201661EN UPG EK4428GVDEEU7 IM
Type of Artwork:	Instruction Manual
Size:	A5 ONLINE 9 PAGE
Software Used:	Indesign CC21
Typefaces:	Myriad Pro, Marydale

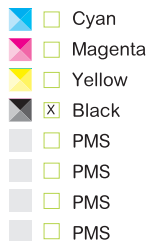

Artwork Version 1

Artwork Scale 1:1

©2021 UP Global Sourcing. All designs, images and artwork are the copyright of UP Global Sourcing. No copying, alterations or amendments to the artwork, design can be undertaken without prior written permission of UP Global Sourcing. Any costs incurred as a result of unauthorised amendments will be recovered from the supplier responsible.

DO NOT PRINT THIS PAGE
ARTWORK REFERENCE ONLY